

MAGPRO 35 Adjust 1s

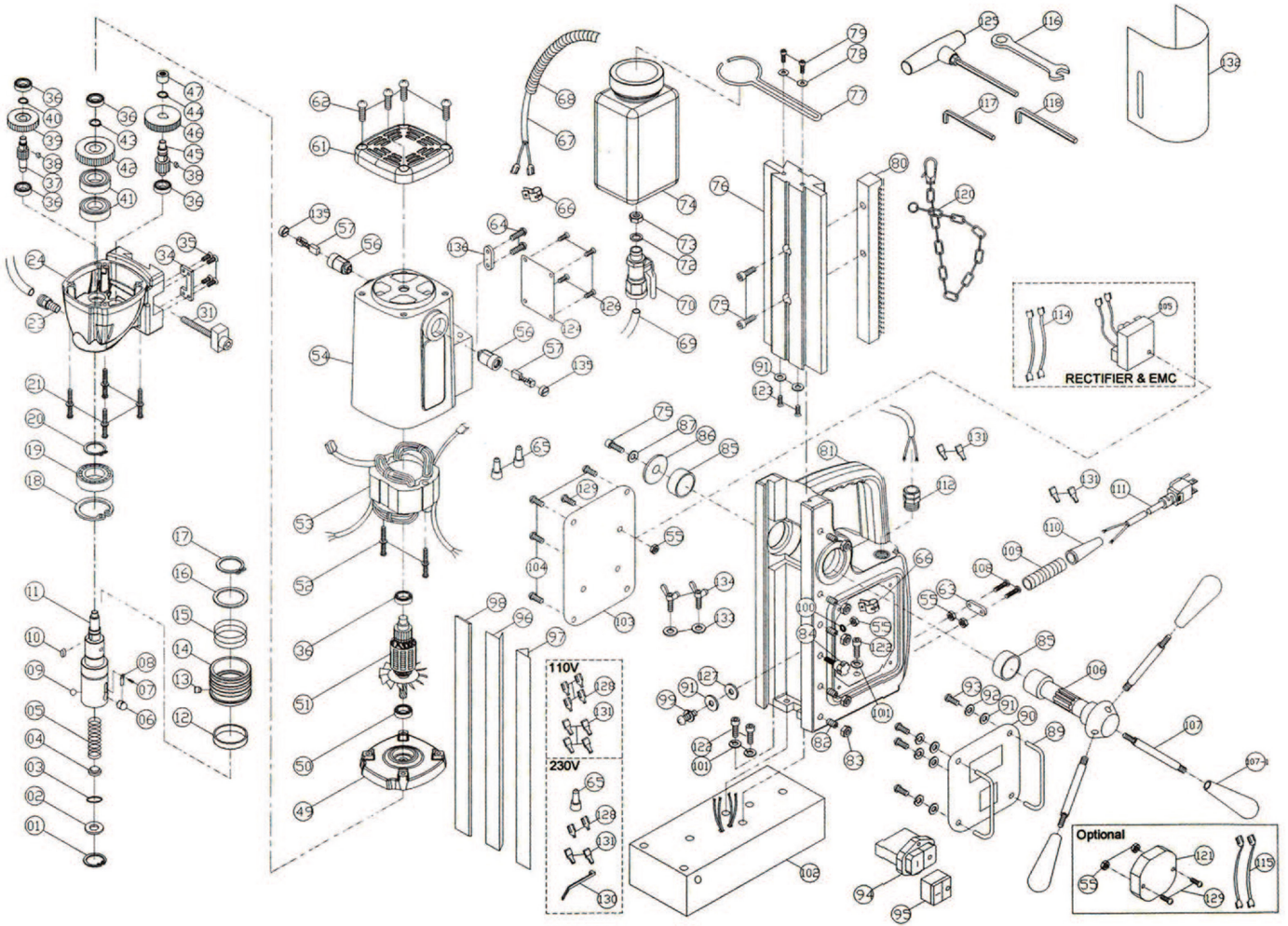

MagPro 35 Adj 1S | 490150 1

| ITEM | PART NO | Q'TY | PART NAME | Price in € excl. VAT | |
|---------|-----------|------|--------------------------|-----------------------|----------|
| 1.) | MA351S001 | 1 | INTERNAL CIRCLIP | R-19 | 0.60 € |
| 2.) | MA351S002 | 1 | ARBOR WASHER | φ10 x φ18.5 x 0.8 | 0.60 € |
| 3.) | MA351S003 | 1 | O-RING | 12 x 4 | 0.60 € |
| 4.) | MA351S004 | 1 | COOLANT SEAL | φ12 x φ10.2 x 15 | 2.30 € |
| 5.) | MA351S005 | 1 | SPRING | φ1.2 x φ10.1 x φ12.5 | 1.20 € |
| 6.) | MA351S006 | 1 | LOCKING PIN | 12.3mm | 7.90 € |
| 7.) | MA351S007 | 1 | SET SCREW | M3 x 4 | 0.60 € |
| 8.) | MA351S008 | 1 | LOCKING PIN SPRING | | 1.70 € |
| 9.) | MA351S009 | 1 | CHECK BALL | φ8 | 1.20 € |
| 10.) | MA351S010 | 1 | PARALLEL KEY | M5 x 5 x 10 | 1.70 € |
| 11.) | MA351S011 | 1 | SPINDLE | | 105.00 € |
| 12.) | MA351S012 | 1 | RING | φ40 x φ44 x 9 | 1.70 € |
| 13.) | MA351S013 | 1 | COLLAR PIN | | 3.40 € |
| 14.) | MA351S014 | 1 | QUICK-RELEASE COLLAR | | 53.90 € |
| 15.) | MA351S015 | 1 | SPRING | φ39 x φ43 x 3T x 30L | 1.70 € |
| 16.) | MA351S016 | 1 | SPRING SEAT RING | φ35.1 x φ44.5 x 2 | 3.40 € |
| 17.) | MA351S017 | 1 | EXTERNAL CIRCLIP | S-35 | 0.60 € |
| 18.) | MA351S018 | 1 | INTERNAL CIRCLIP | R-47 | 1.20 € |
| 19.) | MA351S019 | 1 | BEARING | 6005 zz | 30.40 € |
| 20.) | MA351S020 | 1 | EXTERNAL CIRCLIP | S-25 | 0.60 € |
| 21.) | MA351S021 | 4 | SCREW | M5 x 65 | 0.60 € |
| 23.) | MA351S023 | 1 | COOLANT CONNECTOR | | 4.50 € |
| 24.) | MA351S024 | 1 | GEAR CASE | | 122.40 € |
| 31.) | MA351S031 | 1 | HEIGHT LOCK | | 50.60 € |
| 34.) | MA351S034 | 1 | LOCK BRACKET | | 4.50 € |
| 35.) | MA351S035 | 4 | SCREW | M4 x 10 | 0.60 € |
| 36.) | MA351S036 | 5 | BEARING | 608 ZZ | 7.30 € |
| 37.) | MA351S037 | 1 | MAINSHAFT PINION | H:M1.0 x 17T ; L:M1.0 | 22.50 € |
| 38.) | MA351S038 | 2 | PARALLEL KEY | M4 x 4 x 8 | 1.20 € |
| 39.) | MA351S039 | 1 | INPUT GEAR | M1.0 x 36T | 32.00 € |
| 40.) | MA351S040 | 1 | EXTERNAL CIRCLIP | S-10 | 0.60 € |
| 41.) | MA351S041 | 2 | OIL SEAL | φ25 x φ40 x 7 | 2.90 € |
| 42.) | MA351S042 | 1 | OUTPUT GEAR | M1.25 x 37T | 34.30 € |
| 43.) | MA351S043 | 1 | EXTERNAL CIRCLIP | S-15 | 0.60 € |
| 44.) | MA351S044 | 1 | EXTERNAL CIRCLIP | S-12 | 0.60 € |
| 45.) | MA351S045 | 1 | INTERMEDIATE GEAR PINION | M1.25 x 12T H&L | 26.40 € |
| 46.) | MA351S046 | 1 | INTERMEDIATE GEAR | H:M1.0 x 40T ; L:M1.0 | 29.20 € |
| 47.) | MA351S047 | 1 | NEEDLE BEARING | HK 0810 | 7.30 € |
| 49.) | MA351S049 | 1 | GEAR PLATE | | 39.30 € |
| 50.) | MA351S050 | 1 | BEARING | 6001 LLU | 23.10 € |
| 51.) | MA351S051 | 1 | ARMATURE | 220 V | 108.40 € |
| 52.) | MA351S052 | 2 | SCREW | M5 x 60 | 0.60 € |
| 53.) | MA351S053 | 1 | STATOR | 220 V | 67.40 € |
| 54.) | MA351S054 | 1 | MOTOR HOUSING | | 35.40 € |
| 55.) | MA351S055 | 7 | NUT | M4 x 8 | 0.60 € |
| 56.) | MA351S056 | 2 | BRUSH HOLDER | | 7.90 € |
| 57.) | MA3532 | 1 | CARBON BRUSH SET | 7 x 11 | 23.10 € |
| 61.) | MA351S061 | 1 | MOTOR TAIL COVER | | 5.10 € |
| 62.) | MA351S062 | 2 | SCREW | M5 x 12 | 0.60 € |
| 63.) | MA351S063 | 2 | CABLE CLIP | | 0.60 € |
| 64.) | MA351S064 | 2 | SCREW | M4 x 14 | 0.60 € |
| 65.) | MA351S065 | 2 | WIRE CONNECTOR | C4 | 0.60 € |
| 66.) | MA351S066 | 2 | CABLE CLAMP | | 1.20 € |
| 67.) | MA351S67 | 1 | MOTOR CABLE | 1.0 x 2C x 65cm | 6.80 € |
| 68.) | MA351S68 | 1 | CABLE PROTECTOR | 40cm | 2.90 € |
| 69.) | MA3552 | 1 | COOLANT TUBE | 20cm | 0.60 € |
| 70-74.) | MA3547SET | 1 | COOLANT TANK | | 27.00 € |
| 75.) | MA351S075 | 3 | CAP BOLT | M6 x 16 | 0.60 € |
| 76.) | MA351S076 | 1 | SLIDE | | 107.30 € |
| 77.) | MA3546 | 1 | COOLANT TANK BRACKET | | 3.40 € |
| 78.) | MA3545 | 2 | FLAT WASHER | φ5 x φ12 x 1 | 0.60 € |
| 79.) | MA351S79 | 2 | SOCKET CAP SCREW | M5 x 16 | 0.60 € |

MagPro 35 Adj 1S | 490150 1

| | | | | | |
|-------|-----------|---|--------------------|-----------------|----------|
| 80.) | MA351S080 | 1 | GEAR RACK | | 19.10 € |
| 81.) | MA351S081 | 1 | STAND BODY | | 265.00 € |
| 82.) | MA351S082 | 5 | GIB SET SCREW | M5 x 20 | 0.60 € |
| 83.) | MA351S083 | 5 | GIB LOCK NUT | M5 | 0.60 € |
| 84.) | MA351S084 | 1 | THUMB SCREW | M5 x 16 | 2.90 € |
| 85.) | MA351S085 | 2 | BUSHING | ψ32 x ψ28 x 12 | 1.70 € |
| 86.) | MA351S086 | 1 | FLAT WASHER | ψ40 x ψ6 x 2.5 | 1.20 € |
| 87.) | MA351S087 | 1 | FLAT WASHER | ψ6 x ψ25 x 1 | 0.60 € |
| 89.) | MA351S089 | 2 | SWITCH GUARD BAR | | 6.80 € |
| 90.) | MA351S090 | 1 | SWITCH PANEL | | 5.10 € |
| 91.) | MA351S091 | 4 | FLAT WASHER | ψ4 x ψ10 x 1 | 0.60 € |
| 92.) | MA351S092 | 4 | SPRING WASHER | M4 | 0.60 € |
| 93.) | MA351S093 | 4 | SCREW | M4 x 16 | 0.60 € |
| 94.) | MA3559 | 1 | MOTOR SWITCH | 220V | 51.10 € |
| 95.) | MA3560 | 1 | MAGNET SWITCH | | 8.50 € |
| 96.) | MA351S096 | 1 | GIB STRIP - LEFT | | 13.50 € |
| 97.) | MA351S097 | 1 | GIB STRIP - RIGHT | | 13.50 € |
| 98.) | MA351S098 | 1 | GIB TENSIONER | 260 x 11 x 2.3 | 2.90 € |
| 99.) | MA351S099 | 1 | SCREW | M4 x 16 | 0.60 € |
| 100.) | MA351S100 | 1 | SUN WASHER | M5 | 0.60 € |
| 101.) | MA351S101 | 3 | SPRING WASHER | M6 | 0.60 € |
| 102.) | MA351S102 | 1 | MAGNET BASE | 176 x 90 x 55.5 | 344.10 € |
| 103.) | MA351S103 | 1 | SIDE PANEL | | 5.70 € |
| 104.) | MA351S104 | 4 | SCREW | M4 x 8 | 0.60 € |
| 105.) | MA351S105 | 1 | RECTIFIER & EMC | 220V/110V | 39.90 € |
| 106.) | MA351S106 | 1 | CRANK SPINDLE | | 64.00 € |
| 107.) | MA351S107 | 3 | CRANK HANDLE | | 12.40 € |
| 108.) | MA351S108 | 4 | SCREW | M4 x 30 | 0.60 € |
| 109.) | MA351S109 | 1 | STRAIN RELIEF | 7cm | 0.60 € |
| 110.) | MA351S110 | 1 | CORD ARMOR | | 0.60 € |
| 111.) | MA3586 | 1 | POWER SUPPLY CABLE | 1.0 x 3C x 2.5M | 27.00 € |
| 112.) | MA351S112 | 1 | CABLE GLAND | | 7.90 € |
| 114.) | MA351S114 | 2 | LEAD WIRE | YELLOW | 1.70 € |
| 115.) | MA351S115 | 4 | LEAD WIRE | BLACK | 1.70 € |
| 116.) | MA351S116 | 1 | WRENCH | M8 | 4.50 € |
| 117.) | MA351S117 | 1 | L-HEX KEY | M2.5 | 0.60 € |
| 118.) | MA351S118 | 1 | L-HEX KEY | M4 | 0.60 € |
| 120.) | MA351S120 | 1 | SAFETY CHAIN | | 15.20 € |
| 121.) | MA351S121 | 1 | OVERLOAD UNIT | 220V | 73.00 € |
| 122.) | MA351S122 | 3 | CAP BOLT | M6 x 20 | 0.60 € |
| 123.) | MA351S123 | 2 | PAN HEAD SCREW | M4 x 6 | 0.60 € |
| 124.) | MA351S124 | 1 | MOTOR COVER PLATE | | 13.50 € |
| 125.) | MA351S125 | 1 | T-HANDLE HEX KEY | M6 | 6.80 € |
| 126.) | MA351S126 | 4 | SCREW | M4 x 8 | 0.60 € |
| 127.) | MA351S127 | 1 | RUBBER WASHER | M4 | 0.60 € |
| 128.) | MA351S128 | 4 | TERMINALS | | 0.60 € |
| 129.) | MA351S129 | 3 | SCREW | M4 x 25 | 0.60 € |
| 130.) | MA351S130 | 1 | STRAP | | 0.60 € |
| 131.) | MA351S131 | 8 | Cable Clip | | 0.60 € |
| 132.) | MA351S132 | 1 | CHIP GUARD KIT | | 5.70 € |
| 133.) | MA351S133 | 2 | WASHER | ψ6 x ψ13 x 1 | 0.60 € |
| 134.) | MA351S134 | 2 | SCREW | M6 x 10 | 2.30 € |
| 135.) | MA351S135 | 2 | BRUSH CAP | 7 x 11 | 1.20 € |
| 136.) | MA351S136 | 1 | CABLE CLIP | | 0.60 € |
| 137.) | MA35111 | 1 | Earthing Marking | | 0.60 € |